

Horizontal Clamps

IPHTONZ



The IPHTONZ / IPHSZ horizontal lifting clamps are for use in the lifting and transfer in horizontal position of non-sagging materials or of bundles of non-sagging material. These clamps must be used in pairs or more.

For Horizontal Lifting and Transfer

- Available in capacities of .75 thru 25 metric tons.
- Wide variety of jaw openings available: 0 to 4".
- Welded alloy steel body for strength and smaller size. Forged alloy components, where required.
- Individually Proof Tested to 2 times the Working Load Limit with certification.
- Company name (IP), logo, Working Load Limit and jaw opening permanently stamped on body.
- Each product is individually serialized, with the serial number and Proof Load test date stamped on body. Serial number is included on the test certificate with maintenance and warranty logbook.
- Minimum WLL of 10% of Maximum WLL.
- Maintenance replacement kits are available.
- Manufactured by a ISO 9001 facility.

IPOHOZ



The IPOHOZ horizontal lifting clamp is to be used for lifting and transferring, in the horizontal position, of thin sheet and other materials that will sag or bend when lifted. These clamps must be used in pairs or more.

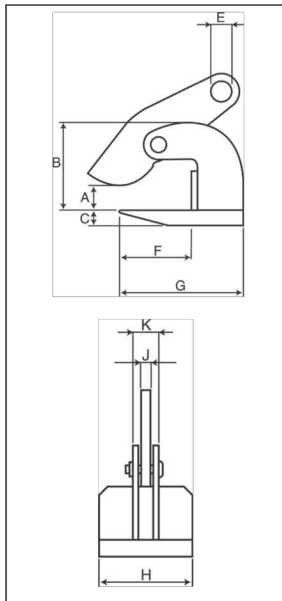

Model IPHTONZ: Jaw opening range 0 to 2-3/8"

Model	Working Load Limit per pair (t)*	IPHTONZ Stock No.	Weight Each (lbs.)	Dimensions (in.)								
				Jaw A	B	C	E	F	G	H	J	K
IPHTONZ	0.75	2705343	10	0 - 1.18	2.95	0.63	0.63	2.52	4.64	3.19	0.47	1.81
IPHTONZ	1.5	2705344	20	0 - 2.38	4.8	0.63	0.86	3.86	6.03	4.33	0.63	2.05
IPHTONZ	3	2705477	30	0 - 2.38	4.61	0.78	1.03	3.86	6.42	4.72	0.78	2.72
IPHTONZ	4.5	2705483	40	0 - 2.38	5.2	0.98	1.19	3.89	7.2	5.13	0.78	2.72
IPHTONZ	6	2705484	49	0 - 2.38	5.2	1	1.42	4.25	8.39	5.13	0.78	2.72
IPHTONZ	9	2705485	69	0 - 2.38	6.19	1.19	1.69	4.64	8.78	5.52	1	3.41
IPHTONZ	12	2705486	84	0 - 2.38	6.77	1.19	1.84	5.28	10	5.91	1	3.47
IPHTONZ	15	2705487	102	0 - 2.38	7.81	1.19	1.84	5.67	11.19	7.88	1	3.47
IPHTONZ	25	2705119	172	0 - 2.38	6.66	1.58	1.84	6.69	11.81	8.66	1.27	4.45

* Ultimate load is 5 times the Working Load Limit.

Model IPHSZ : Jaw opening range 0 to 4"

Model	Working Load Limit per pair (t)*	IPHSZ Stock No.	Weight Each (lbs.)	Dimensions (in.)								
				Jaw A	B	C	E	F	G	H	J	K
IPHSZ	3	2705308	49	0 - 4.00	7.56	0.78	1.03	6.3	8.73	5.52	0.78	2.56
IPHSZ	6	2705311	73	0 - 4.00	7.88	1	1.27	6.3	9.8	7.09	0.78	2.72
IPHSZ	9	2705313	106	0 - 4.00	8.66	1.19	1.38	6.69	10.63	7.48	1	2.34
IPHSZ	12	2705318	128	0 - 4.00	8.66	1.38	1.84	6.69	10.63	7.88	1	2.73

* Ultimate load is 5 times the Working Load Limit.

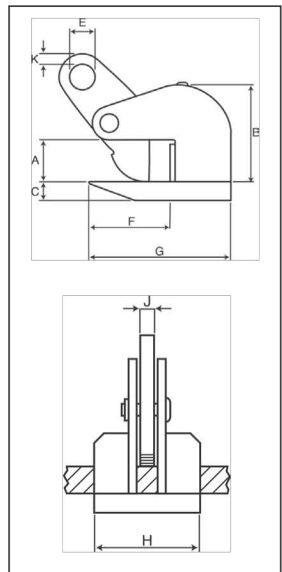

Model IPOHOZ : Jaw opening range 0 to 2-3/8"

Model	Working Load Limit per pair (t)*	IPOHOZ Stock No.	Weight Each (lbs.)	Dimensions (in.)								
				Jaw A	B	C	E	F	G	H	J	K
IPOHOZ	0.75	2705401	13	0 - 1.18	3.53	0.63	0.63	2.75	4.64	3.19	0.47	0.47
IPOHOZ	1.5	2705402	24	0 - 1.75	5.23	0.63	0.86	4.92	7.56	3.94	0.63	0.47
IPOHOZ	3	2705403	35	0 - 1.75	5.39	0.78	1.03	4.92	7.88	4.72	0.78	0.39
IPOHOZ	4.5	2705404	38	0 - 1.75	5.44	0.98	1.19	4.95	8.66	4.72	0.78	0.39
IPOHOZ	6	2705405	63	0 - 2.38	6.73	1.19	1.42	5.31	9.25	5.13	0.78	0.78
IPOHOZ	9	2705406	93	0 - 2.38	8.31	1.19	1.69	6.53	10.86	6.3	1	0.78
IPOHOZ	12	2705407	95	0 - 2.38	8.55	1.58	1.84	6.61	11.58	7.48	1	0.75
IPOHOZ	15	2705408	167	0 - 2.38	8.66	1.58	1.84	7.2	12.48	9.84	1	0.86

* Ultimate load is 5 times the Working Load Limit.