

UNC Swivel Hoist Rings

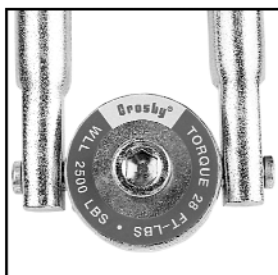

SEE APPLICATION AND WARNING INFORMATION

HR-125



- Top washer has the following features:
- The Working Load Limit and Recommended Torque value are permanently stamped into each washer.
- Washer is color coded for easy identification: Red - UNC thread.
- Bolt specification is a Grade 8 Alloy socket head cap screw to ASTM A 574. All threads listed are UNC.
- BOLT SIZE IDENTIFICATION: The size of the bolt will be stated as in the drawing below. Illustration shows meaning of each dimension given.

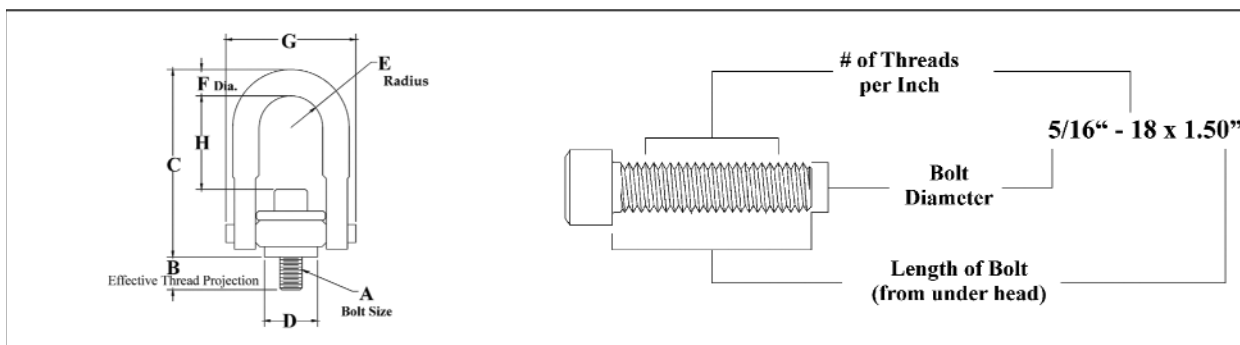

HR-125 UNC Threads

Frame Size No.	HR-125 Stock No.	Working Load Limit (lbs.) [†]	Torque in Ft. Lbs.	Dimensions (in.)								Weight Each (lbs.)
				Bolt Size A ‡	Effective Thread Projection Length B	C	D	Radius E	Diameter F	G	H	
1 †	1016887	800	7	5/16 - 18 x 1.50	.59	2.69	.94	.46	.34	1.69	1.11	.43
1 †	1016898	1000	12	3/8 - 16 x 1.50	.59	2.69	.94	.46	.34	1.69	1.09	.43
2	1016909	2500	28	1/2 - 13 x 2.00	.71	4.82	2.00	.88	.69	3.30	2.29	2.49
2 †	1016912	2500	28	1/2 - 13 x 2.50	1.21	4.82	2.00	.88	.69	3.30	2.29	2.52
2	1016920	4000	60	5/8 - 11 x 2.00	.71	4.82	2.00	.88	.69	3.30	2.21	2.55
2 †	1016924	4000	60	5/8 - 11 x 2.75	1.46	4.82	2.00	.88	.69	3.30	2.21	2.70
2	1016931	5000	100	3/4 - 10 x 2.25	.96	4.82	2.00	.88	.69	3.30	2.05	2.65
2 †	1016935	5000	100	3/4 - 10 x 2.75	1.46	4.82	2.00	.88	.69	3.30	2.05	3.00
3	1016942	7000	100	3/4 - 10 x 2.75	.90	6.55	3.00	1.37	.94	4.73	2.98	7.00
3 †	1016946	7000	100	3/4 - 10 x 3.50	1.65	6.55	3.00	1.37	.94	4.73	2.98	7.00
3	1016953	8000	160	7/8 - 9 x 2.75	.90	6.55	3.00	1.37	.94	4.73	2.85	7.00
3 †	1016957	8000	160	7/8 - 9 x 3.50	1.65	6.55	3.00	1.37	.94	4.73	2.85	7.00
3	1016964	10000	230	1 - 8 x 3.00	1.15	6.55	3.00	1.37	.94	4.73	2.73	7.50
3 †	1016969	10000	230	1 - 8 x 4.00	2.15	6.55	3.00	1.37	.94	4.73	2.73	7.50
4	1016975	15000	470	1-1/4 - 7 x 4.50	2.22	8.70	3.75	1.69	1.19	6.00	3.92	14.79
5	1016986	24000	800	1-1/2 - 6 x 6.50	2.98	12.39	4.75	2.25	1.69	8.00	5.94	33.00
5	1016997	30000	1100	2 - 4-1/2 x 6.50	2.98	12.39	4.75	2.25	1.69	8.00	5.14	36.00
6	1017001	50000	2100	2-1/2 - 4 x 8.00	4.00	16.88	5.75	3.00	2.25	11.69	8.00	88.00
7	1017005	75000	4300	3 - 4 x 10.50	5.20	19.50	7.25	3.75	2.75	14.12	8.50	165.00
8	1017009	100000	6600	3-1/2 - 4 x 13.00	7.00	22.06	7.75	4.00	3.25	16.00	9.25	240.00

* Ultimate Load is 5 times the Working Load Limit.

† Long Bolts are designed to be used with soft metal (i.e., aluminum) work piece. While the long bolts may also be used with ferrous metal (i.e., steel & iron) work piece, short bolts are designed for ferrous work pieces only.

‡ Bolt specification is a Grade 8 Alloy socket head cap screw to ASTM A 574.

Metric Swivel Hoist Rings



SEE APPLICATION AND WARNING INFORMATION

HR-125M



- Top washer has the following features:
- The Working Load Limit and Recommended Torque value are permanently stamped into each washer.
- Washer is color coded for easy identification: Silver - Metric thread.
- Bolt specification is a Grade 12.9 Alloy socket head cap screw to Din 912. All threads listed are metric (ASME/ANSI B18.3.1m).
- Designed to be used with ferrous work piece only.
- **BOLT SIZE IDENTIFICATION:** The size of the bolt will be stated as in the drawing below. Illustration shows meaning of each dimension given.

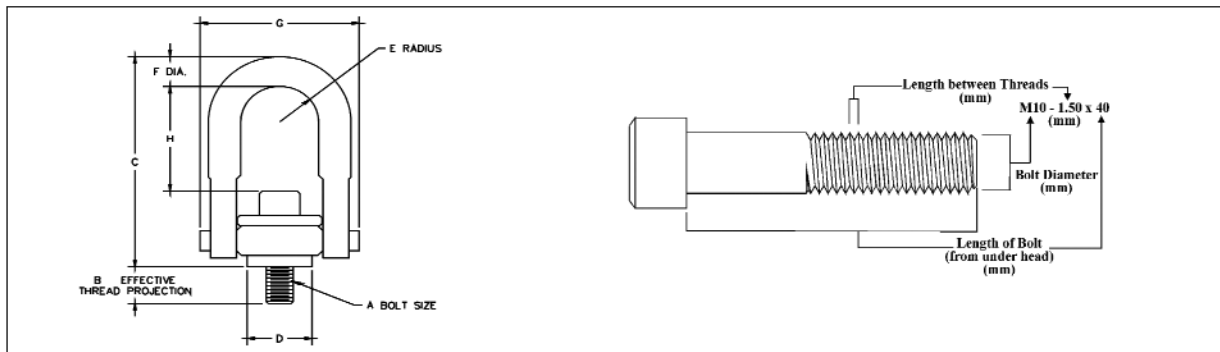

HR-125M Metric Threads

HR-125M Stock No.	Working Load Limit (kg)		Torque In Nm*	Dimensions (mm)								Weight Each (kg)
	At a 5:1 Design Factor †	At a 4:1 Design Factor †		(A) Bolt Size ‡	(B) Effective Thread Projection Length	C	D	Radius E	Dia. F	G	H	
1016602	400	500	10	M8X1.25X40	16.9	68.1	25.4	11.8	8.5	42.9	28.2	.19
1016613	450	550	16	M10X1.50X40	16.9	68.1	25.4	11.8	8.5	42.9	27.69	.19
1016624	1050	1300	38	M12X1.75X50	17.2	124.5	50.8	22.3	17.5	82.7	58.17	1.13
1016635	1900	2400	81	M16X2.00X60	27.2	124.5	50.8	22.3	17.5	82.7	56.13	1.22
1016644	2150	2700	136	M20X2.50X65	31.2	124.5	50.8	22.3	17.5	82.7	52.07	1.36
1016657	3000	3750	136	M20X2.50X75	28.1	167.0	76.2	34.7	25.4	120.1	75.69	3.18
1016668	4200	5250	312	M24X3.00X80	33.1	167.0	76.2	34.7	25.4	120.1	74.93	3.18
1016679	7000	8750	637	M30X3.50X120	65.1	231.5	95.3	44.5	30.5	152.4	69.34	6.70
1016690	11000	13750	1005	M36X4.00X150	60.6	315.3	120.7	57.2	44.5	203.2	124.20	14.95
1016701	12500	15600	1005	M42X4.50X160	70.6	315.3	120.7	57.2	44.5	203.2	150.62	16.33
1016712	13500	16900	1350	M48X5.00X160	70.6	315.3	120.7	57.2	44.5	203.2	137.92	16.33

* The tightening torque values shown are based upon threads being clean, dry and free of lubrication.

† Individually proof loaded to 2-1/2 times the Working Load Limit based on the 4:1 design factor.

‡ Bolt specification is a Grade 12.9 Alloy socket head cap screw to Din 912. All threads are metric (ASME/ANSI B18.3.1m).